

3/4" Rectangular (19mm) Multi-Turn Cermet Trimmer

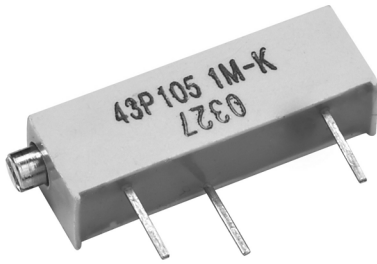

The Model 43 is manufactured to the highest international standards. This product, sealed to 85°C for 1 minute (IEC. 68-2-17) has an effective travel of 20 turns nominal and a resistance range of 10Ω to 2MΩ.

FEATURES

- Panel mount, clear lid versions available
- Chevron shaft for sealing and smooth consistent torque
- Unique "T" slider block for excellent stability and setability
- Solder plated terminals for good solderability
- Solder terminations for improved reliability
- I.C. style pins for easier board insertion
- Multi-finger wiper for better C.R.V.

DIMENSIONS in inches (millimeters)

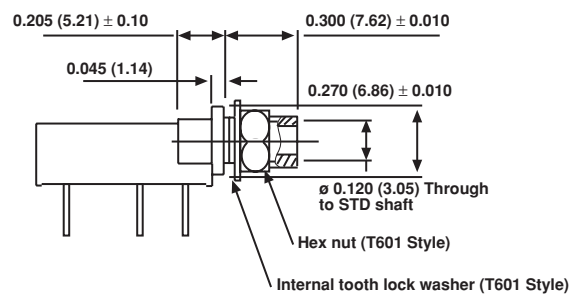
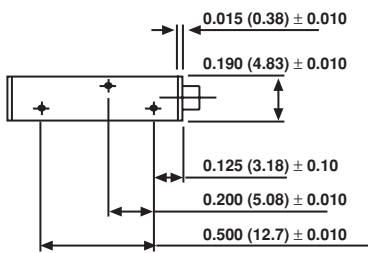
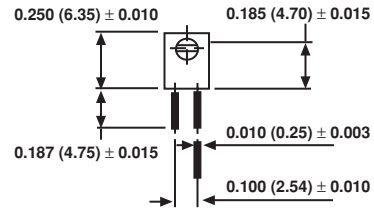
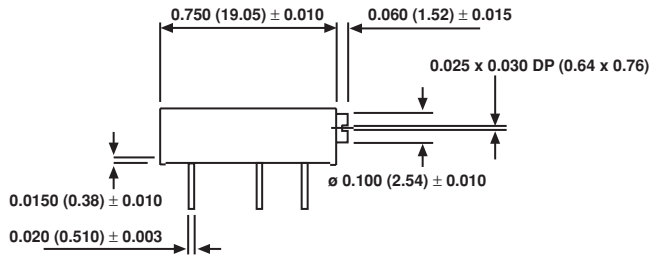

CIRCUIT DIAGRAM





3/4" Rectangular (19mm)
Multi-Turn Cermet Trimmer

Vishay Spectrol

ELECTRICAL SPECIFICATIONS	
Resistive Element	cermet
Electrical Travel	20 turns nominal
Resistance Range	10Ω to 2MΩ
Resistance Tolerance	± 10%
Power Rating	0.5W at + 70°C, derated linearly to zero watts at 125°C Maximum voltage not to exceed 400V
Temperature Coefficient of Resistance	± 100ppm/°C. 100Ω to 2MΩ - 100 to 200ppm/°C. 10Ω, 20Ω and 50Ω
Contact Resistance Variation	1% Rn or 1Ω, whichever is greater
End Resistance	2Ω or 1%, whichever is greater
Dielectric Withstanding Voltage	1000VAC at sea level, 250VAC at 80, 00 feet (24, 000 meters)
Insulation Resistance (500VDC)	1000MΩ minimum

MECHANICAL SPECIFICATIONS	
Rotational Life	200 cycles min. ±2% res.
Operating Torque	5 oz (35mNm) max
End Stop Torque	wiper idles against stop
Unit Weight (max. g)	1.13
Stability	± 0.05% RT

ENVIRONMENTAL SPECIFICATIONS	
Temperature Range	- 55°C to + 125°C
Climatic Category	55 / 125 / 21

ENVIRONMENTAL SPECIFICATIONS						
TESTS	CONDITIONS	MAX R	CHANGE VAB VAC	PER CECC 41100	PER IEC 68.1 PART	PER MIL 202F
Bumps	390m/s ² , 4000	1%	-	(PARA) 2.3.3	TEST EB (IEC 68-2-29)	NO EQUIV
Vibration	98m/s ² , 10 to 500Hz	1%	2%	(PARA) 2.3.2	TEST FC (IEC 68-2-6)	METHOD 204
Electrical Endurance	1000 hours	3%	-	(PARA) 2.5.16	-	NO EQUIV
Soldering	-	-	-	(PARA) 2.3.7	TEST TB (IEC 68-2-20)	METHOD 208
Resistance to Heat	-	1%	-	(PARA) 2.3.7	TEST TB (IEC 68-2-20A)	METHOD 210 METHOD 1A
Damp Heat Steady Rate	21 days	3%	-	(PARA) 2.1	TEST C (IEC 68-2-3)	METHOD 103
Sealing	85°C for 1 minute	-	-	AS IEC	TEST QC (IEC 68-2-17)	METHOD 112
Mechanical Life	200 cycles	3%	-	-	METHOD 2	-
Terminal Strength	2.2lbs (1kg)	min	-	-	-	-

MARKING

- Printed:
- VISHAY trademark
 - model
 - style
 - ohmic value (in Ω, kΩ, MΩ)
 - tolerance (in %)
 - manufacturing date
 - marking of terminal 3

ORDERING INFORMATION		
43P MODEL AND PIN STYLE	SPECIAL (omit if standard) T601 - Panel mount T602 - Base rise	103 EIA RESISTANCE VALUE

SAP PART NUMBERING GUIDELINES														
M	4	3	P	1	0	3	K	B	4	0	□	□	□	□
MODEL				OHMIC VALUE			TOL	PACKAGING CODE			SPECIAL (IF APPLICABLE)			
See the end of this data book for conversion tables														



Notice

Specifications of the products displayed herein are subject to change without notice. Vishay Intertechnology, Inc., or anyone on its behalf, assumes no responsibility or liability for any errors or inaccuracies.

Information contained herein is intended to provide a product description only. No license, express or implied, by estoppel or otherwise, to any intellectual property rights is granted by this document. Except as provided in Vishay's terms and conditions of sale for such products, Vishay assumes no liability whatsoever, and disclaims any express or implied warranty, relating to sale and/or use of Vishay products including liability or warranties relating to fitness for a particular purpose, merchantability, or infringement of any patent, copyright, or other intellectual property right.

The products shown herein are not designed for use in medical, life-saving, or life-sustaining applications. Customers using or selling these products for use in such applications do so at their own risk and agree to fully indemnify Vishay for any damages resulting from such improper use or sale.